

## LDSUC Add-on Connector

### Overview:

#### Application

Branching out from any area of already existing cable runs.  
Protection against  
cable slipping from the run while pulling and using.

#### Material

Steel, strip-galv. acc. to the Sendzimir method to PN-EN 10346:2011 (SG)

#### Available to order:

**F**- steel, hot-dip galv. to PN-EN ISO 1461:2011 (HDG)

**E**- stainless steel (SS)

**L**- powder coating in a full range of colours (PC)

**Quick and firm installation to any area of cable tray: no hole drilling necessary!**

**Important! The Add-on Connector should be adjusted to the tray side heights:**

- LDSUC1 will suit long span cable trays and ladders H100
- LDSUC2 will suit long span cable trays and ladders H110
- LDSUC3 will suit long span cable trays and ladders H120, H150, and H200.

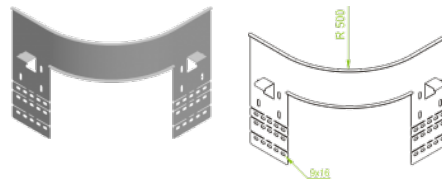

### Versions:

Sheet thickness: 2,0 mm

| Symbol | Catalogue number | Quantity in box | Weight 1 pc. |
|--------|------------------|-----------------|--------------|
| LDSUC1 | 205001           | 2               | 1,19         |
| LDSUC2 | 205002           | 2               | 1,26         |
| LDSUC3 | 205003           | 2               | 1,87         |